

FUEL SYSTEM

WARNING:

When replacing fuel line parts, be sure to observe the following:

- Put a "CAUTION: INFLAMMABLE" sign in workshop with a CO₂ fire extinguisher.
 - Be sure to furnish the workshop with a CO₂ fire extinguisher.
 - Be sure to disconnect battery ground cable before conducting operations.
 - Put drained fuel in an explosion-proof container and put on lid securely.
- Do not disconnect any fuel line unless absolutely necessary.
 - Plug hose and pipe openings to prevent entry of dust or dirt.
 - Always replace O-ring and clamps with new ones.
 - Do not kink or twist hose and tube when they are installed.
 - Do not tighten hose clamps excessively to avoid damaging hoses.
 - When installing fuel check valve, be careful of its designated direction (Refer to section EC).
 - Run the engine and check for leaks at connections.

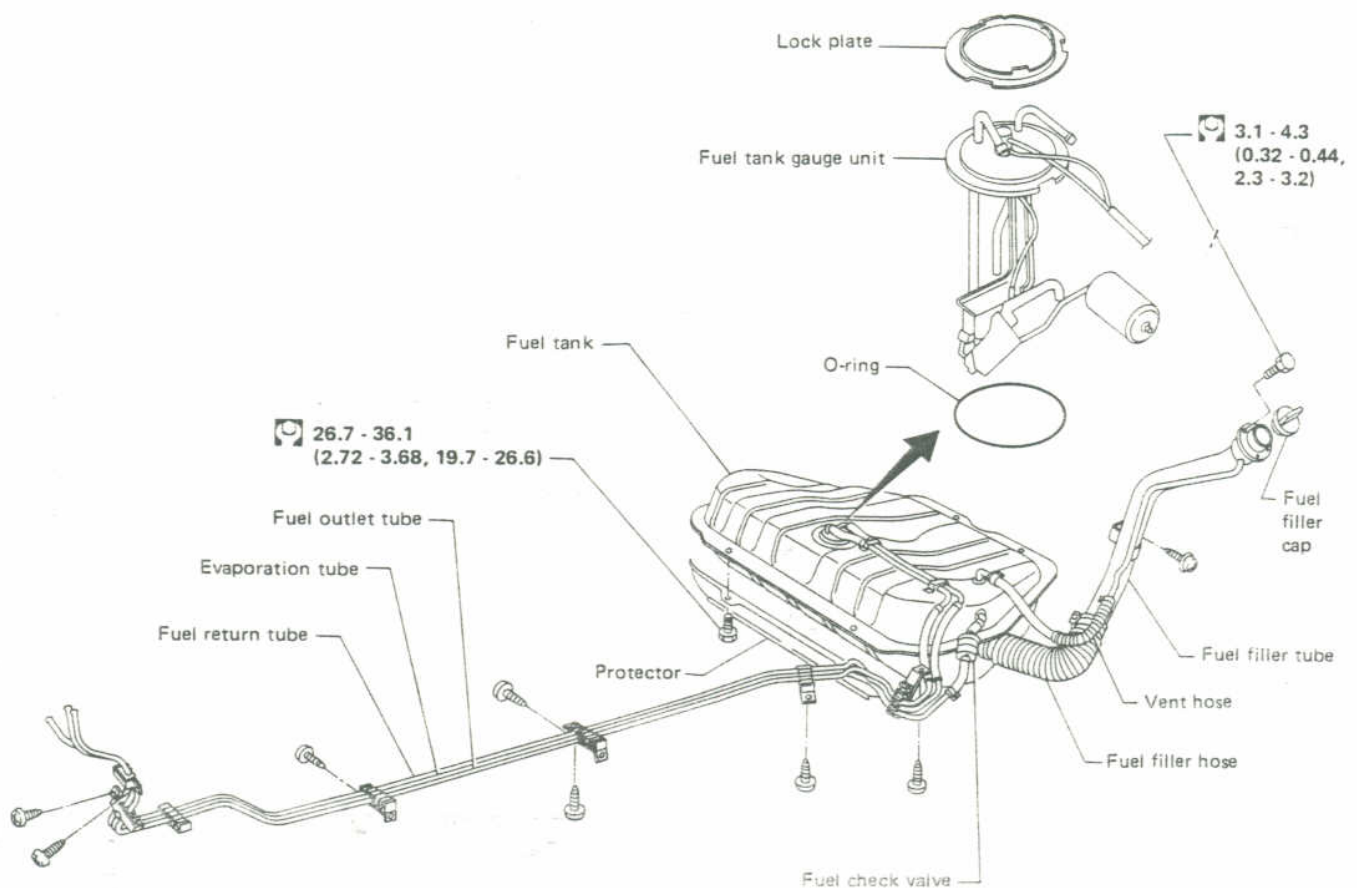

: N·m (kg·m, ft·lb)

SFE849